



Commercial



The IP Lock and Security Company



Education



Retail



Government



Healthcare

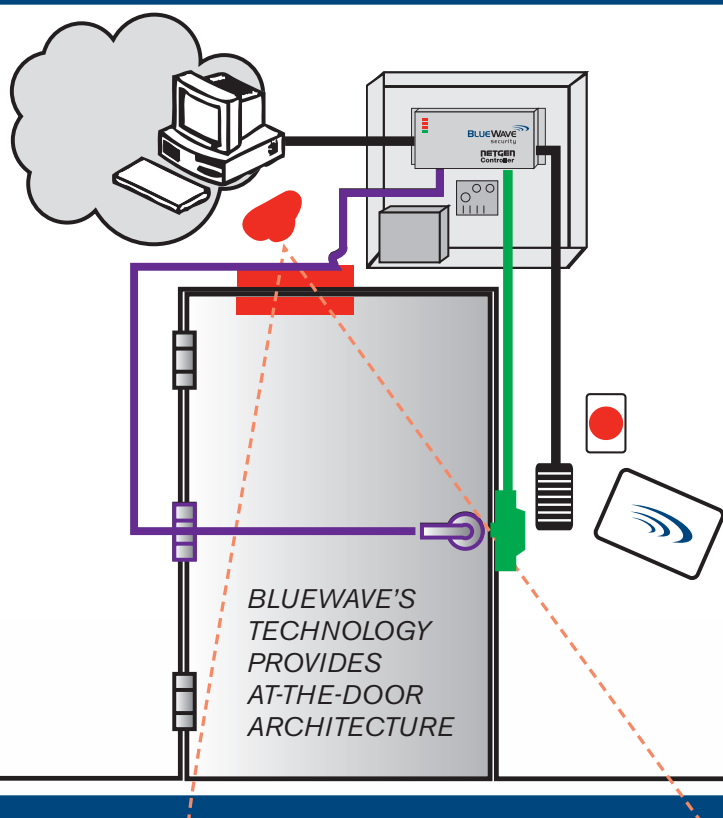

BlueWave Security Provides One Source Supply of Access Control

Hardware

- One source for all IP access system components
- Full array of door locking devices available

Software

- **BLUEVIEW** Enterprise, Professional and Express software available
- Active Directory, Video and Notification modules

Support

- Experienced Support Team in Physical Security Industry for IP Access Control
- All hardware and software support is handled in-house, in the U.S.A.

Hardware Categories

NETGEN™ Controllers

- **Ethernet:** POE, Power Supply Kit, Board Only
- NetGen 1 door controller is UL294 Listed



Credential Readers

- Keypads
- BluePass/Smart Phone
- Keypad/Prox Combo
- Prox
- Single gang, Mullion Mount, Vandal Resistant options available



Locking Devices

- Exit Devices; Switch Bars
- Elec. Hinges
- Elec. Locksets
- Mag Locks
- Door Strikes
- Conversion Kits



Accessories

- Prox Cards (26 bit)
- Fobs (26 bit)
- Door Contacts
- Door Loops
- Cam Locks



REX Sensors

- Key Switches
- Push Buttons
- Motion Sensors
- Touch Switches



- One Source Supply of all Hardware in all Product Categories
- Extended Warranties are available up to 5 years

Scale from One Door to Thousands with the Same Platform

Common Door Systems:

All 3 Door Systems Require:

- Controller
- Credential Cards / FOBs
- Door Locking Hardware
- Software **BLUEVIEW**

1 Electric Strike

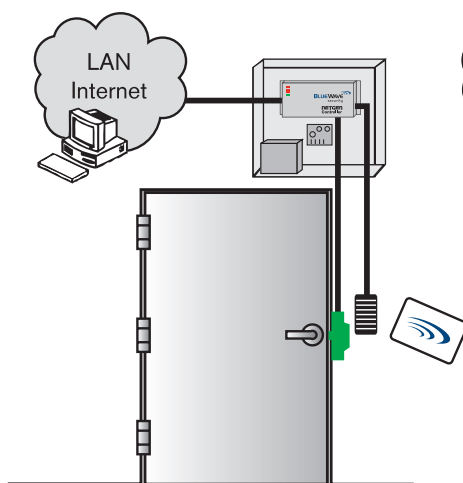

For System #1 add:

- ✓ Door Strike

2 Electromagnetic (Mag Lock)

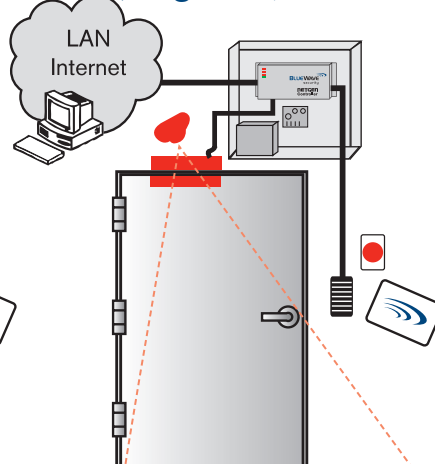

For System #2 add:

- Mag Lock
- REX Motion
- REX Switch

3 Electrified Locksets

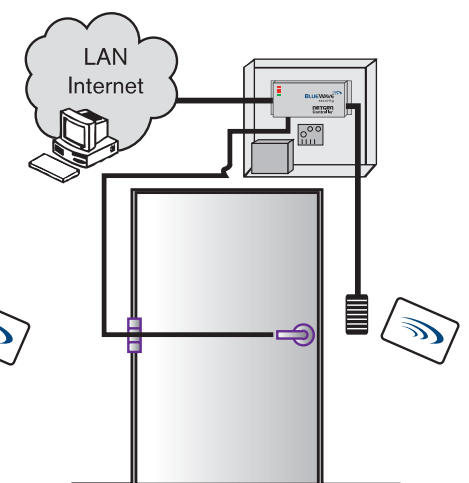

For System #3 add:

- Cylindrical or Mortise Lockset
- Electrified Hinge



* Door contacts can be added to any system

The BLUEVIEW Software

Download the latest version at: www.BlueWaveSecurity.com/downloads

Features:

- Automatic Unlock Shifts
- Manager & Employee Shifts (First-in-shift)
- Unlock With Card Shift
- Multiple Credentials per User
- One Software Works on all Windows based Platforms
- NO Required Annual Fees

	EXPRESS	PROFESSIONAL	ENTERPRISE
Part #	BVExp	BVPro	BVEnt
# of Doors	<30	<60	Unlimited
# of Clients	0	5	Unlimited
# of Users	3	5	Unlimited
# of Cardholders	500	5,000	Unlimited

MODULES

Active Directory / Sync Service*		Optional	Included
Video Module		Optional	Included
Import Cards Utility		Included	Included
Command Notification		Optional	Included
Web Interface		Optional	Included

System Requirements & Compatibility with:
Microsoft Windows XP or newer, Microsoft SQL Server 2012, Microsoft Windows Server 2012, Microsoft Windows 8 and Microsoft Active Directory.

System Expansion available with Software Licenses for Express and Professional.

Advanced Database Synchronization Capabilities
ODBC, LDAP and AD

Support

Tel: 760-929-9596

Email: Sales@BlueWaveSecurity.com
Support@BlueWaveSecurity.com
Marketing@BlueWaveSecurity.com

Website: www.BlueWaveSecurity.com
TechTips.BlueWaveSecurity.com

Webinars: www.BlueWaveSecurity.com/sales/upcoming-webinars

BlueWave Security team offers sales and technical support by phone, by remote access dial in, and through scheduled appointments onsite.

Certified Installer Program

The BlueWave Security Installer Program provides advanced product and software training in working with all components of the BlueWave access control system.

We offer trainings by webinar or on-site, as scheduled. Certified Installers receive access to TechTips, an online technical resource created by BlueWave Security specifically for our Installer Program to advance to the next level.

Contact Sales@BlueWaveSecurity.com for more details!

BLUEWAVE
security

CONTROLLER

SOFTWARE

CREDENTIAL
READER

LOCKING
DEVICE

REX SENSOR

ACCESSORIES

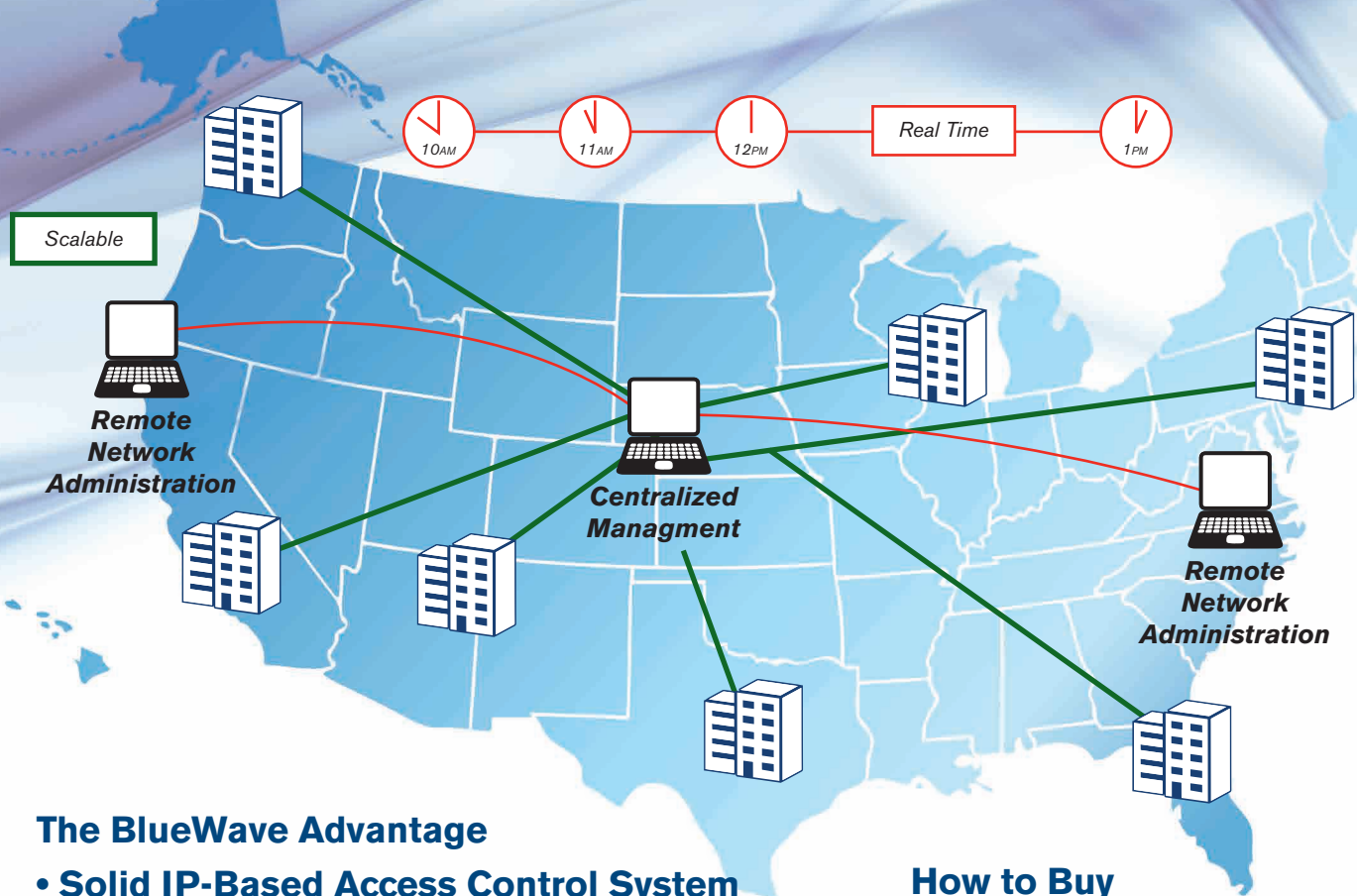

The BlueWave Advantage

• Solid IP-Based Access Control System

Proven - hundreds of end-product user customers since 2006

Scalable - ability to expand from one door to thousands at one location or at multiple sites

Reliable & Secure - everything runs on your physical network, not cloud dependent

• One Source Provider of Hardware, Software & Support

One Stop - supply a complete end-to-end system from the door hardware through to the network infrastructure

Experience - a pioneer in IP access control with a highly knowledgeable team in physical security management, product development, engineering and installation

• BlueWave Saves Time and Money

Quick ROI - save 20-30% compared to a panel based system in material and labor costs

Timely Projects - eliminate long cable runs and save on project completion time

Upfront Costs - expand and purchase doors as needed with no worry of annual fees or required contracts

Lowest Cost of Ownership - for purchase and system expansion of any access control system in the industry

How to Buy

Visit www.BlueWaveSecurity.com/partners



Distributor Partner
Sell Through Distribution



Rep Group
Field and Sales Support

Accu-Tech[®]

We're Known by the Companies We Keep

BLUEWAVE
security

2270 Camino Vida Roble, Suite K
Carlsbad, CA 92011

BlueWaveSecurity.com